

RTS11-ON-2U

1-3kVA PF=0,9



RTS11-ON-1k0-2U-D4-2x9-I4

RTS11-ON-2k0-2U-D6-2x9-I8

RTS11-ON-3k0-2U-D6-6x9-I9







CE RoHS  VFI-SS-111



Features

<ul style="list-style-type: none"> • Pure sine output 	<ul style="list-style-type: none"> • Hot-swap – easy AGM batt replacement
<ul style="list-style-type: none"> • True online double conversion – topology VFI-SS-111 High-frequency 	<ul style="list-style-type: none"> • DSP control porcesor
<ul style="list-style-type: none"> • RACK 19" case 	<ul style="list-style-type: none"> • Input power factor – 0,99 • Output power factor – 0,9
<ul style="list-style-type: none"> • Voltage and frequency independent 	<ul style="list-style-type: none"> • Fan auto-regulated • MENU function
<ul style="list-style-type: none"> • Battery auto-charge 	<ul style="list-style-type: none"> • New charger design, 90% capacity restore in 3hours
<ul style="list-style-type: none"> • Autodiagnostic, communication 	<ul style="list-style-type: none"> • Cold start
<ul style="list-style-type: none"> • User menu interface 	<ul style="list-style-type: none"> • Many transmission protocol

Typical application

		
Telecommunication systems	Servers	Industrial
		
Data center	Measurments	Drives

Technical parameters

MODEL	RTS11-ON-1k0-2U-D4-2x9-I4	RTS11-ON-2k0-2U-D6-4x9-I8	RTS11-ON-3k0-2U-D6-6x9-I9
Rated power (reactive/active)	1000VA/900W	2000VA/1800W	3000VA/2700W
INPUT			
Input voltage	Rated: 230VAC (208V / 220V / 230V / 240V) Input voltage range: 176Vac – 280Vac Bypass: -25%...+15% rated		
Input voltage frequency	40-70Hz Autoselection		
Power factor	PF >0,99		
Connector:	Socket IEC C14		Socket IEC C20
OUTPUT			
Output voltage	Mains mode: 230Vac +/- 1%, Battery mode: 230Vac +/- 1%, Other settings: 208V, 220V, 240V		
Output voltage frequency	50/60Hz ± 1% (auto selection)		
Wave form	Mains mode: pure sine Battery mode: pure sine		
Transfer time	Mains -> battery: 0ms To bypass: 4ms		
THD	THD <2% linear THD <5% non-linear		
Output sockets	IEC C13 4pcs	IEC C13 8pcs	IEC C13 8pcs, C19 1pcs
Efficiency	Mains mode: >90% Battery mode: >85% ECO mode: >95%	Mains mode: >91% Battery mode: >86% ECO mode: >96%	Mains mode: >92% Battery mode: >87% ECO mode: >97%
PF	0,9		
Crest factor	3:1		
Load type	Resistance, inductor, rectifier		
Overload protections	105%...125%: transfer to bypass after 1min 125%...150%: transfer to bypass after 30sek >150%: transfer to bypass after 300ms		
BATTERY			
Type:	Lead-acid VRLA AGM, voltage 12V		
Charger current:	1A		
Montage:	Hot-swap case on front panel		
Battery q-ty :	2 x 9Ah12V	4 x 9Ah12V	6 x 9Ah12V
Battery model:	IPSH 9-12L MWH 9-12L	IPSH 9-12L MWH 9-12L	IPSH 9-12L MWH 9-12L
Charger voltage:	24Vdc	48Vdc	72Vdc
Charger time:	3-5h		

MODEL	RTS11-ON-1k0-2U-D4-2x9-14	RTS11-ON-2k0-2U-D6-4x9-18	RTS11-ON-3k0-2U-D6-6x9-19
Rated power (reactive/active)	1000VA/900W	2000VA/1800W	3000VA/2700W
BACKUP TIME			
Backup for 100% load	2min	2min	2min
Backup for 75% load	5min	5min	4min
Backup for 50% load	9min	9min	7min
Backup for 25% load	21min	25min	21min
Additional battery pack:	1szt KU-BAT-2URT-2x9-BC24	1szt KU-BAT-2URT-4x9-BC48	1szt KU-BAT-2URT-6x9-BC72
DIMMENSION & WEIGHT			
Weight netto/brutto (kg)	10,6 / 11,3 kg	18,7/21,8 kg	26,8/29,7 kg
Dimmension w/d/h. (mm) a/b(d)/c	440/290(320)/89 mm (2U)	440/405(430)/89 mm (2U)	440/533(562)/89 mm
Package w/d/h (mm)	545/428/194 mm	545/560/201 mm	545/690/201 mm
Pallet	20pcs	20pcs	20pcs
ALARMS			
Fail	Long beep 4 sek		
Low battery level	beep 1 sek		
Protections	2x beep / 1sek		
Utility error	beep		
PROTECTIONS			
Full protection	Overload, short-circuit, overvoltage, temperaturę, overdischarge, deep discharge		
ENVIRONMENT			
Humidity	20~90% RH @ 0~40°C (non-condensated)		
Noise	Fan rotation auto-selected		
COMMUNICATION			
Port USB (w standardzie) Port RS232 (w standardzie)	Linux, Windows®98 Server 2016, and Windows®98/2000/2003/XP/Vista/2008/Windows®7/Windows®8/ Windows®10/, UPSmart software		
Slot na kartę rozszerzeń: (jedno miejsce)	KU-CARD-SNMP, Ethernet communications		
	KU-CARD-AS400, dry contacts		
EPO (w standardzie)	Wejście EPO – Emergency Power OFF		
STANDARDS			
Conversion type:	VFI-SS-111		
LVD:	EN62040-1:2008		
EMC:	EN62040-1:2008 + A1:2013		
	EN61000-3-2:2014		
	EN61000-3-3:2013		

All specifications are subject to change without notice.

DIMMENSIONS:

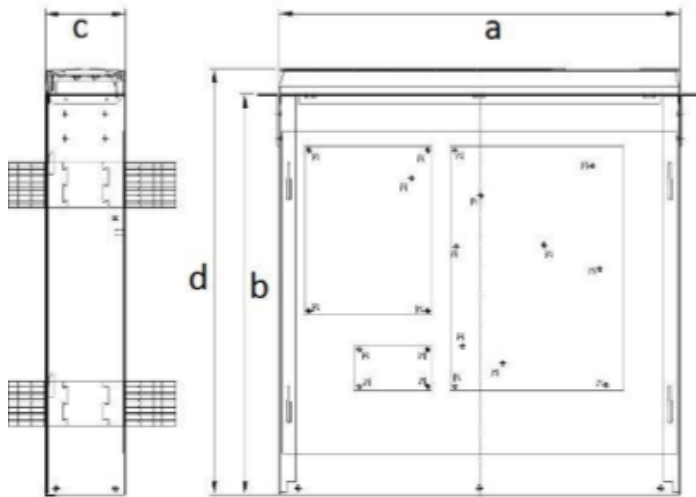

Batteries Hot-Swap:

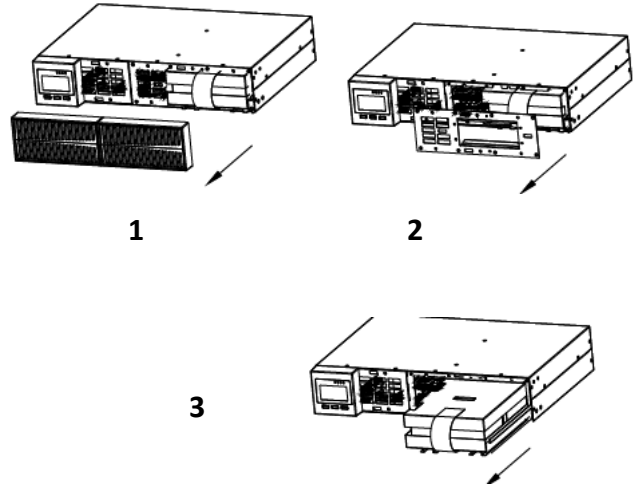

MODEL	RTS11-ON-1k0-2U-D4-2x9-I4	RTS11-ON-2k0-2U-D6-4x9-I8	RTS11-ON-3k0-2U-D6-6x9-I9
EAN	5902135156100	5902135156117	5902135156124
Tylny panel			

Rear panel:

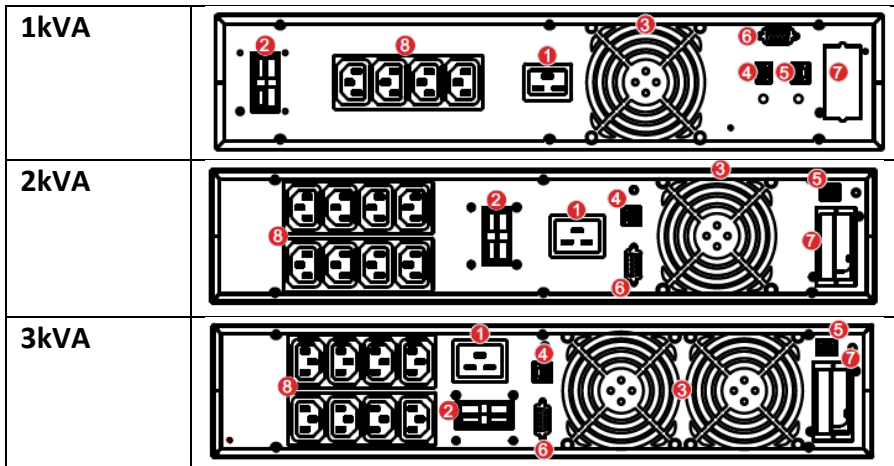

1	AC input socket	5	EPO
2	Battery connector socket	6	RS232 port
3	Fan	7	Intelligent card slot
4	USB port	8	Output sockets IEC

Accessories:

IPSH 9-12L		AGM battery
KU-BAT		Battery cabinet
KU-RACKRAIL-19"		Mounting Rail
KU-CARD-SNMP-IDA-ST200		Intelligence SNMP and Modbus card
KU-CARD-IDM-AS401P		Dry contact
KU-MBS11-3k-1U		Maintenance bypass